



**APPLICATION FOR
SHORELINE STABILIZATION PERMIT**

Dear Claytor Lake Property Owners:

On behalf of Appalachian Power Company (Appalachian), please find attached an application for a shoreline stabilization and a sample drawing for your reference. Instructions for completing this application include the following:

1. Read the entire permit application carefully.
2. To help ensure a prompt response, please include all requested information. Incomplete applications will be returned for additional information.
3. The Shoreline Management Plan (SMP) for the Claytor Project, dated November 14, 2022, as approved by Order Approving Revised Shoreline Management Plan Pursuant to Article 414 issued June 28, 2023 can be found at claytorhydro.com. The proposed shoreline stabilization must meet the requirements of the SMP before it can be approved.
4. A site visit will be conducted upon receipt of the application. Please call the number listed below if you or your contractor would like an appointment to discuss stabilization options within the Project boundary.
5. The property owner, not an agent or contractor, is required to sign the permit application. Applications with incorrect signatures will be returned.
6. Property information, including the parcel identification number, legal description, and deed reference information can be obtained by contacting Pulaski County. On-line information is available at pulaskicounty.org.
7. Contact the U.S. Army Corps of Engineers (Corps) to ensure compliance with existing nationwide permits.
8. Mail the completed application to the following address for processing:

Appalachian Power Company
Shoreline Management
996 Old Franklin Turnpike
Rocky Mount, Virginia 24151

9. If the proposal meets the SMP, a permit will be issued. Approved Appalachian permits may be taken to the Pulaski County to obtain the necessary erosion and sediment control permits.
10. Copies of approved county permits must be forwarded to Appalachian for the Appalachian permit to be valid.

Should you have any additional questions, you may contact me at (540) 489-2556.

Sincerely,

Lisa H. Hammock

Lisa H. Hammock
Real Estate Agent Senior

11/02/2023

Permit for Shoreline Stabilization
Appalachian Power Company
Claytor Lake

Appalachian Power Company (APCO) has the authority and responsibility under its Federal Energy Regulatory Commission (FERC) license and its land rights to review and approve activities within the Claytor Project boundary which includes all land generally within the 1850 foot contour (or other areas defined by survey beyond the referenced contour elevation).

All Property Owner's (Permittee's) Name: _____

Mailing Address: _____
(street) (city) (state) (zip)

Telephone: _____
(day) (night) (e-mail)

Location: _____
(subdivision) (section) (lot number)

Lake Address: _____
(street) (city) (state) (zip)

County Tax Map and Parcel No. _____ Deed Book and Page No. or Doc. No. _____

Directions By Land: _____

Shoreline Management Plan Shoreline Classification: (To be completed by APCO) _____

Read the following carefully and fill in or attach the appropriate information.

Shoreline stabilization is allowed in areas of active erosion. No material is to be placed in excess of the minimum needed for erosion control. If existing vegetation is sufficient to control erosion and the shoreline is not actively eroding, the existing vegetation shall remain in place. Permittees are encouraged to consider landscape plantings to control erosion. All parties desiring to stabilize their shoreline must obtain written authorization from APCO prior to beginning any activity / construction inside the Project boundary.

1) Check appropriate box:

- Riprap (If rip rap is to be installed, please indicate if installation will occur by land or water _____)
- Vegetation for controlling erosion
- Bulkhead or Retaining Wall

Note: Routine maintenance to existing riprapped shoreline or bulkhead/retaining wall does not require an APCO permit. (See page 3 of 3 for details.)

2) A map showing the general location of the proposed work (Example: Lake Map).

3) Attach a drawing showing the location of the Project boundary (1850 foot contour elevation), base elevation (1846 foot contour elevation), length of shoreline, all property lines and extended property lines, and the plan view and cross section view of the above erosion control measure with all dimensions.

4) Attach photographs of the total shoreline documenting areas of active erosion.

Date of Photographs: _____

5) Complete the following information:

- a. Total length of stabilization activity as measured along base elevation (1846 feet): _____ ft.
- b. Distance the activity will encroach into the lake as measured from base elevation: _____ ft.
- c. Are wetlands present? Yes ___ No ___
- d. Type and size of solid rock material (Class I= 50-150 pounds; Class II = 150-500 pounds):

- e. Will filter fabric be used? Yes ___ No ___
- f. Slope of final grade (may be no greater than 2:1 (horizontal/vertical): _____
- g. Depth of buried toe: [Minimum of one foot below normal low pool elevation (1844') for Class I and two feet for Class II]

- h. Will the proposed activity alter the Project boundary? (1850 foot contour)
Yes ___ No ___ (**If yes, additional information will need to be forwarded to APCO.)
- i. Anticipated completion date: _____

6) If vegetation must be removed for the installation of riprap, a Vegetation Removal Permit must be submitted which shows the vegetation that will remain as well as the vegetation that will be removed. This application requires a plan to replace the function of the vegetated buffer.

7) See the "Terms and Conditions of Permit" to follow.

Permit for Shoreline Stabilization
Appalachian Power Company
Claytor Lake

By signing this permit, the Permittee accepts the Terms and Conditions herein and acknowledges the following:

APCO, pursuant to its License, has the continuing responsibility to supervise and control the uses and occupancies for which it has granted permission and to monitor the use of and ensure compliance with the conditions under which this permit has been granted. As a result, the use and occupancy hereby permitted is deemed to be made under a **revocable license** from APCO. As such, if the use and occupancy violates any condition of the License or any other condition imposed for the protection and enhancement of the Project's scenic, recreational or other environmental values, or upon the petition of any other permitting agency, APCO shall take such lawful action necessary to address the situation. Such action may include, if necessary, the cancellation of this permit and the removal of the non-complying structures and facilities. Furthermore, any structures or other use associated with this use and occupancy permit must be maintained in good repair and comply with applicable federal, state and local requirements.

I certify that the above information is true and correct, and that I have read and agree to the Terms and Conditions of the permit listed on the back of this form.

_____ Date	_____ Signature of Permittee _____ Print Name	_____ Signature of Permittee _____ Print Name
---------------	--	--

To Be Completed by Authorized APCO Representative – Permit is Invalid without a Signature.

This permit is granted solely for the purpose described by the Permittee in this permit:

_____ Date Issued	_____ Date of Site Visit (if applicable)	_____ Signature / Title of APCO Representative
----------------------	---	---

Permit for Shoreline Stabilization
Appalachian Power Company
Claytor Lake

TERMS AND CONDITIONS OF PERMIT

This permit is granted by APCO and accepted by the Permittee, subject to the following terms and conditions:

1. This permit is granted solely for the purpose of erosion control. No addition or design change shall be made to this permitted stabilization structure without prior approval from APCO.
2. Routine maintenance to existing riprapped shoreline or bulkhead/retaining wall does not require an APCO permit. Maintenance includes the addition of riprap within the original boundaries of length, width and height and replacement of damaged timber or adding appropriate fill material behind the existing functional bulkhead/wall. Call APCO if you are uncertain whether your project falls into this category.
3. The activity described in this permit is part of a single and complete project.
4. No material is to be placed in excess of the minimum needed for erosion protection.
5. Under this permit, shoreline stabilization shall not alter the Project boundary (1850 foot contour). If altering the project boundary is proposed, additional information shall be submitted to APCO for review.
6. No material shall be placed in a wetland area.
7. The stabilization structure shall not impair surface flows.
8. Tires, scrap metal, crushed block or other types of material that are not aesthetically acceptable are not allowed for stabilization. Only clean solid rock shall be used for stabilization.
9. No attempt shall be made by the Permittee to forbid the full and free use by the public of all navigable waters at or adjacent to the permitted stabilization structure or to unreasonably interfere with navigation in connection with the ownership, construction, operation or maintenance of the permitted stabilization structure.
10. By thirty (30) days' notice, mailed to the Permittee by registered or certified letter, APCO may revoke this permit whenever it determines that the public interest necessitates such revocation or when it determines that the Permittee has failed to comply with the conditions of this permit. The revocation notice shall specify the reason for such action.
11. The Permittee is responsible for proper design, engineering, construction, maintenance and placement of the proposed stabilization structure. APCO's review and approval of the plans are no guarantee or assurance the Permittee's plans are proper or adequate for the purpose intended.
12. The Permittee shall ensure that erosion and sedimentation (E & S) control devices are in place prior to clearing and grading and that they are maintained in good working order to minimize impacts to all waters and wetlands in accordance with the current edition of the Virginia Erosion and Sedimentation Handbook. Any deposition of graded materials in upland areas shall be carried out in such a manner as to prevent the erosion of these materials and preclude their entry into all waters and wetlands. These controls shall remain in place until the area stabilizes. Soil stabilization practices shall be applied to all denuded areas **within seven (7) days** after final grade is reached within any impact area.
13. It is understood and agreed by and between APCO and Permittee that part of the consideration for the granting of this permit for lakeshore use is the Permittee's agreement to keep project lands and waters occupied by and surrounding the permitted facility free of all waste, garbage, and other unsightly debris and materials and is to comply with local health rules and regulations.
14. It is understood that the water levels at Claytor Lake can fluctuate from time to time, especially during periods of high inflow or during scheduled drawdowns of the reservoir. These fluctuations in elevation should be taken into consideration when designing erosion control structures.
15. In the event that any previously known or unknown cultural resource materials are discovered, all work associated with this permit must be stopped. APCO must be notified and consultation with the State Historic Preservation Office (SHPO) must be completed before any further work within the work area will be allowed to continue. In addition:
 - A. The applicant shall notify APCO and SHPO immediately and follow-up with a written account of the discovery. The applicant may be required to employ an archaeologist who meets or exceeds the qualifications described in the Secretary of the Interior's Professional Qualifications Standards (48 FR 44738-9) to assess the eligibility of the resource for inclusion in the National Register.
 - B. If the resource is determined to be eligible for inclusion in the National Register, and the applicant wishes to continue with the activity, the applicant shall ensure that an archaeologist who meets or exceeds the qualifications described in the Secretary of the Interior's Professional Qualifications Standards (48 FR 44738-9) shall prepare a plan for its avoidance, protection, or recovery of information. The SHPO shall approve such plan, prior to implementation.
 - C. Work in the affected area shall not proceed until either:
 - a. Appropriate data recovery or other approved mitigation procedures are developed and implemented, or
 - b. The determination is made that the located resources are not eligible for inclusion on the National Register.
16. Permittee agrees to all conditions set forth in the Shoreline Management Plan (SMP) for the Claytor Project, dated November 14, 2022, as approved by Order Approving Revised Shoreline Management Plan Pursuant to Article 414 issued June 28, 2023,
17. This APCO permit is contingent upon approved county and U.S. Corps of Engineers permits (if applicable.) Copies of approved permits, once received, must be submitted to APCO for the APCO permit to be valid.

Mail this completed form and any applicable local, state or federal permits to:

Appalachian Power Company
Shoreline Management
996 Old Franklin Turnpike
Rocky Mount, Virginia 24151

PROPERTY OWNER

SAMPLE SUB., LOT #, SEC. #

DATE

SHORELINE STABILIZATION PLAN VIEW

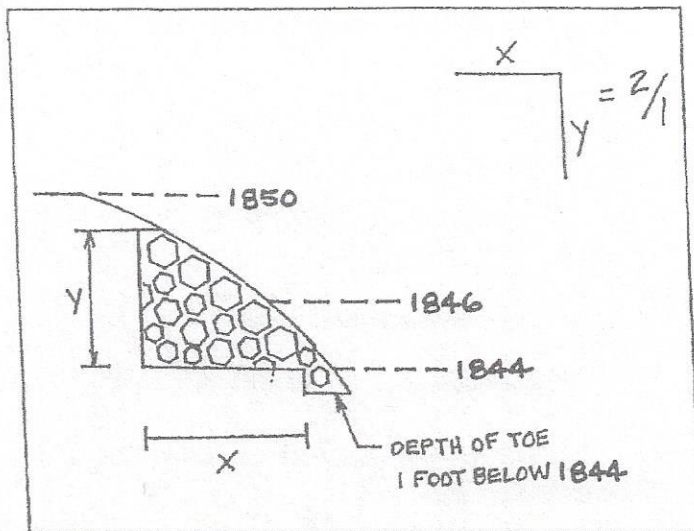

SAMPLE PROPERTY LINE

SAMPLE PROPERTY LINE

TOTAL STABILIZATION = X FEET

 = PROPOSED RIP RAP INSTALLATION

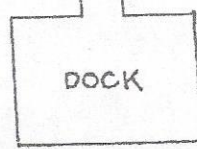
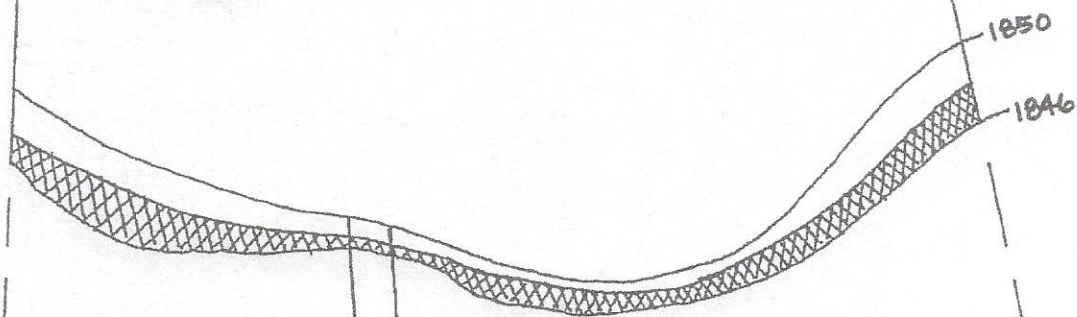

DOCK